

FLOOR : 22 - 24 (Typ)

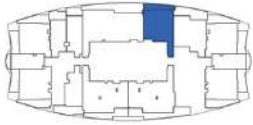

FLOOR : 25 - 45 & 48 - 56 (Typ)

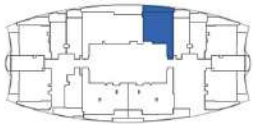

SITE PLAN



1 BEDROOM TYPE - B

AREA in Sq.Ft :

| | |
|--------------|------------|
| Apartment | 647 to 649 |
| Balcony | 110 to 112 |
| Total | 759 |

UNITS:

| FLOOR | UNIT Nos |
|-------------------------|--|
| 22 - 24 (Typ) | (2205) to (2405) |
| 25 - 45 & 48 - 56 (Typ) | (2506) to (4506) & (4806) to (5606) |

FLOOR : 22 - 24 (Typ)

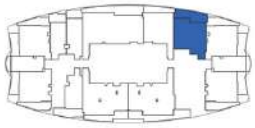

1 BEDROOM TYPE - C

AREA in Sq.Ft :

| | |
|--------------|------------|
| Apartment | 654 |
| Balcony | 193 |
| Total | 847 |

UNITS:

| FLOOR | UNIT Nos |
|---------------|------------------|
| 22 - 24 (Typ) | (2204) to (2404) |

FEATURES : Pool

SITE PLAN

BAYSIDE VIEW



COMMUNITY VIEW



CITY VIEW

PROSPECTIVE ANCHOR VIEW

FLOOR : 21 & 47 (Typ)

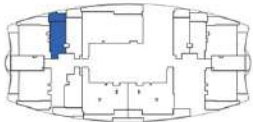

FLOOR : 22 - 24 (Typ)

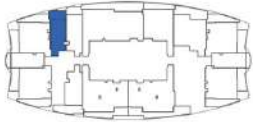

FLOOR : 25 - 45 & 48 - 56 (Typ)

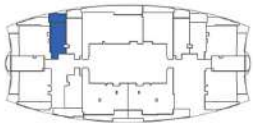

SITE PLAN



PRESIDENTIAL STUDIO - A

AREA in Sq.Ft :

| | |
|--------------|-------------------|
| Apartment | 336 to 337 |
| Balcony | 95 to 97 |
| Total | 431 to 433 |

UNITS :

| FLOOR | UNIT Nos |
|-------------------------|-------------------------------------|
| 21 & 47 (Typ) | (2108) & (4708) |
| 22 - 24 (Typ) | (2208) to (2408) |
| 25 - 45 & 48 - 56 (Typ) | (2509) to (4509) & (4809) to (5609) |

FEATURES : Pool

FLOOR : 21 & 47 (Typ)

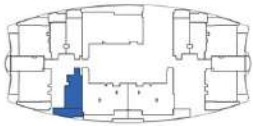

FLOOR : 22 - 24 (Typ)



FLOOR : 25 - 45 & 48 - 56 (Typ)

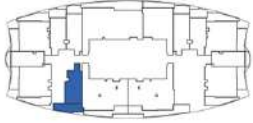

SITE PLAN

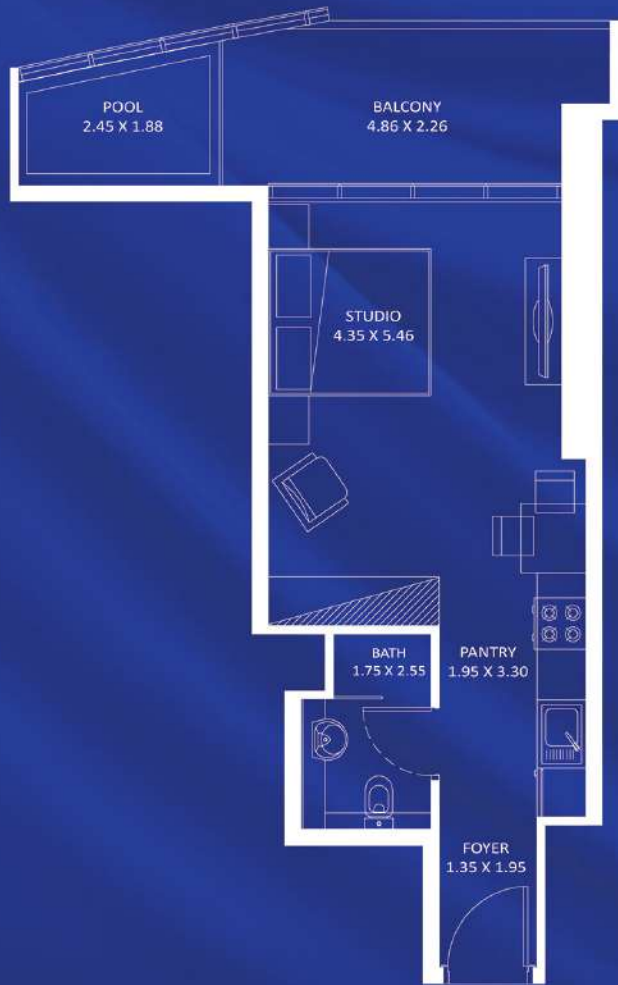

PRESIDENTIAL STUDIO - B

AREA in Sq.Ft :

| | |
|--------------|-------------------|
| Apartment | 375 to 376 |
| Balcony | 153 |
| Total | 528 to 529 |

UNITS :

| FLOOR | UNIT Nos |
|-------------------------|-------------------------------------|
| 21 & 47 (Typ) | (2112) & (4712) |
| 22 - 24 (Typ) | (2212) to (2412) |
| 25 - 45 & 48 - 56 (Typ) | (2513) to (4513) & (4813) to (5613) |

FEATURES : Pool

FLOOR : 2 - 19 (Typ)

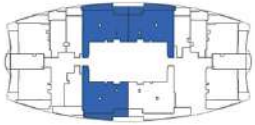

FLOOR : 21 & 47 (Typ)

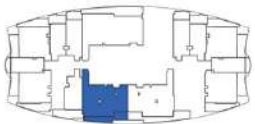

FLOOR : 22 - 24 (Typ)

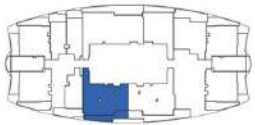

FLOOR : 25 - 45 & 48 - 56 (Typ)

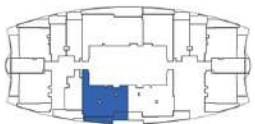

SITE PLAN



2 BEDROOM TYPE - A

AREA in Sq.Ft :

| | |
|--------------|-----------------------|
| Apartment | 891 to 894 |
| Balcony | 177 to 186 |
| Total | 1,070 to 1,078 |

UNITS:

| FLOOR | UNIT Nos |
|-------------------------|---|
| 2 - 19 (Typ) | (206 - 207) (214) to (1906 - 1907) (1914) |
| 21 & 47 (Typ) | (2113) & (4713) |
| 22 - 24 (Typ) | (2213) to (2413) |
| 25 - 45 & 48 - 56 (Typ) | (2514) to (4514) & (4814) to (5614) |

FEATURES : Pool

FLOOR : 2 - 19 (Typ)

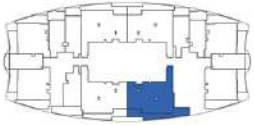

FLOOR : 21 & 47 (Typ)

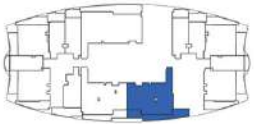

FLOOR : 22 - 24 (Typ)

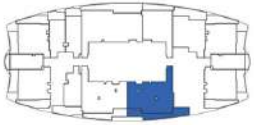

FLOOR : 25 - 45 & 48 - 56 (Typ)

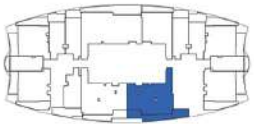

SITE PLAN



2 BEDROOM TYPE - B

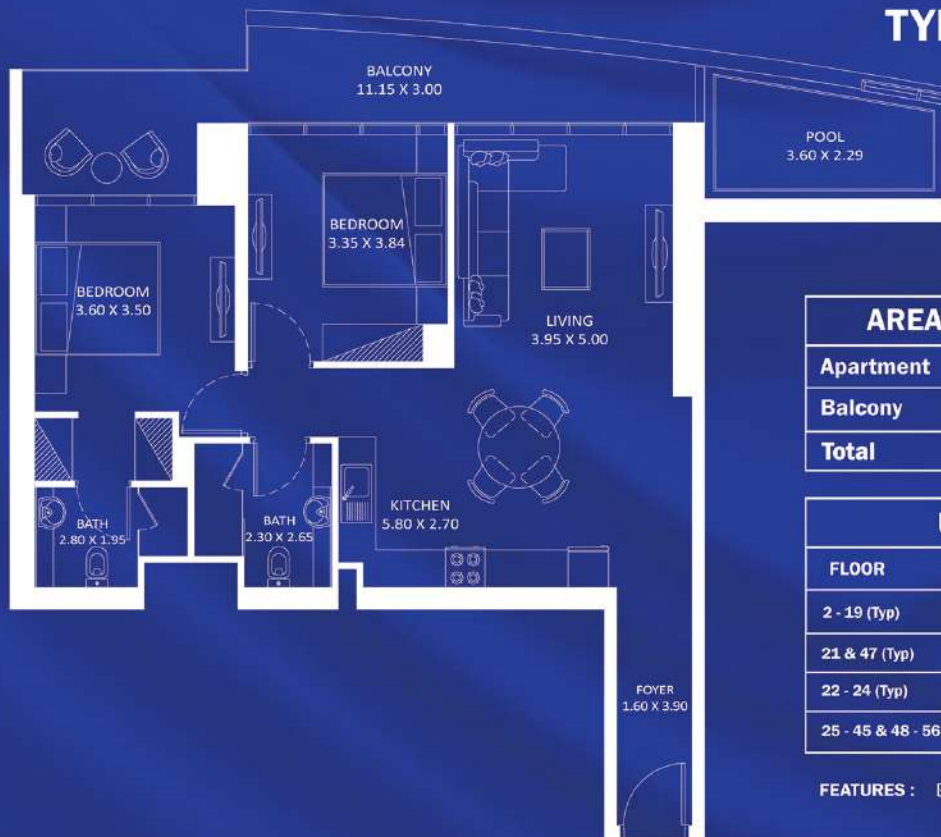

AREA in Sq.Ft :

| | |
|--------------|-----------------------|
| Apartment | 902 to 907 |
| Balcony | 271 to 274 |
| Total | 1,176 to 1,177 |

UNITS:

| FLOOR | UNIT Nos |
|-------------------------|-------------------------------------|
| 2 - 19 (Typ) | (215) to (1915) |
| 21 & 47 (Typ) | (2114) & (4714) |
| 22 - 24 (Typ) | (2214) to (2414) |
| 25 - 45 & 48 - 56 (Typ) | (2515) to (4515) & (4815) to (5615) |

FEATURES : Pool

FLOOR : 21 & 47 (Typ)

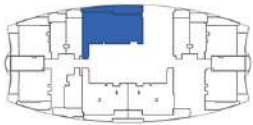

FLOOR : 22 - 24 (Typ)

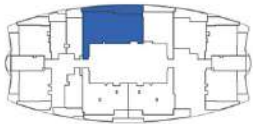

FLOOR : 25 - 45 & 48 - 56 (Typ)

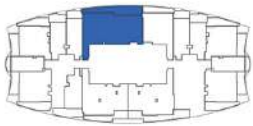

SITE PLAN



3 BEDROOM TYPE - A



| AREA in Sq.Ft : | |
|-----------------|-----------------------|
| Apartment | 1,188 |
| Balcony | 280 to 284 |
| Total | 1,468 to 1,472 |

| UNITS : | |
|-------------------------|-------------------------------------|
| FLOOR | UNIT Nos |
| 21 & 47 (Typ) | (2106) & (4706) |
| 22 - 24 (Typ) | (2206) to (2406) |
| 25 - 45 & 48 - 56 (Typ) | (2507) to (4507) & (4807) to (5607) |

FEATURES : Pool Maid Room

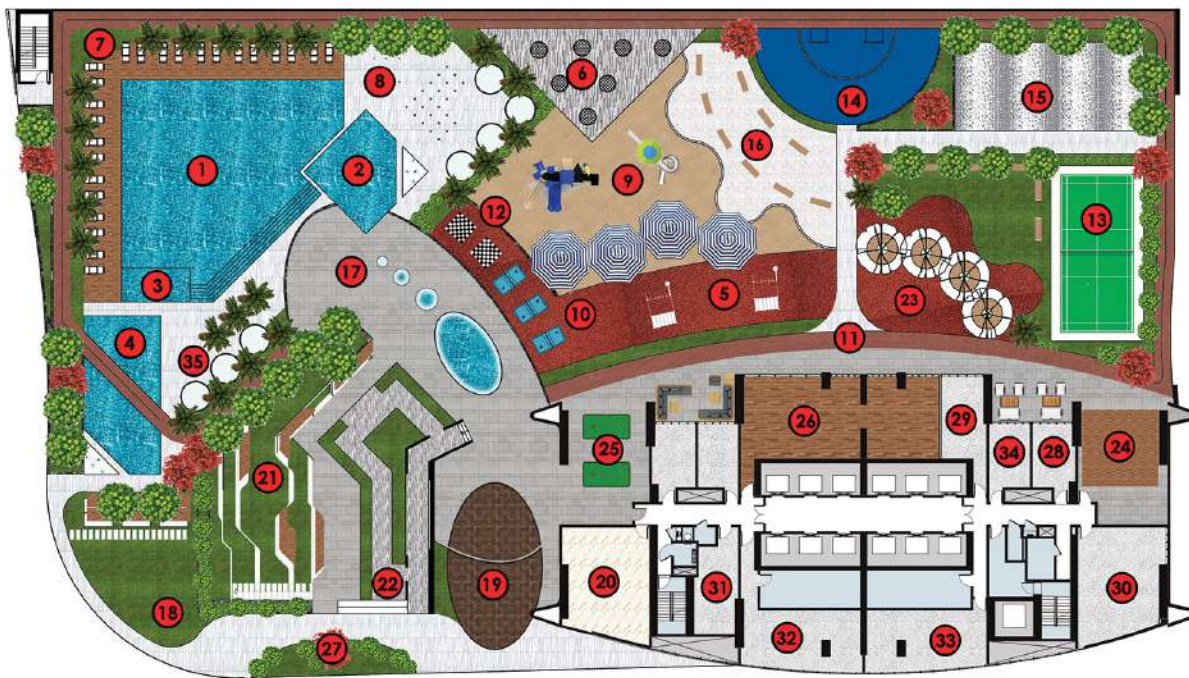

LEGEND

1. Swimming pool
2. Kids pool
3. Jacuzzi
4. Aquatic gym
5. Outdoor fashion gym
6. Trampoline park
7. Pool deck
8. Kids splash pad
9. Kids play area
10. Table tennis zone
11. Jogging track
12. Chess board area
13. Badminton court
14. Multipurpose court
15. Skating park
16. Meditation zone
17. Fashion plaza
18. Japanese garden
19. Outdoor party area
20. Party hall area
21. Outdoor cinema
22. Fashion ramp
23. BBQ area
24. Zumba and dance studio
25. Snooker table zone
26. Fashion gym
27. Open cigar zone
28. Spa & Therapy
29. Doctor on call
30. Fashion school
31. Kids day care
32. Business center
33. Fashion library
34. Beauty parlor
35. Gazebo

HEALTH CLUB LEVEL

FASHIONZ
© Fashionz by DANUBE



FLOOR : 2 - 19 (Typ)

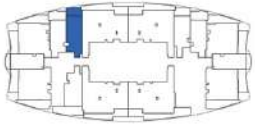

FLOOR : 21 & 47 (Typ)

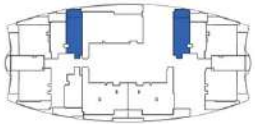

FLOOR : 22 - 24 (Typ)

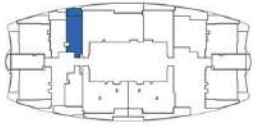

FLOOR : 25 - 45 & 48 - 56 (Typ)

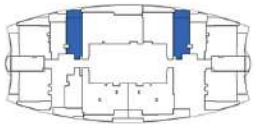

SITE PLAN



EXECUTIVE STUDIO - C

AREA in Sq.Ft :

| | |
|--------------|-------------------|
| Apartment | 377 to 378 |
| Balcony | 80 to 82 |
| Total | 457 to 460 |

UNITS:

| FLOOR | UNIT Nos |
|-------------------------|---|
| 2 - 19 (Typ) | (208) to (1908) |
| 21 & 47 (Typ) | (2105) (2107) & (4705) (4707) |
| 22 - 24 (Typ) | (2207) to (2407) |
| 25 - 45 & 48 - 56 (Typ) | (2505) (2508) to (4505) (4508) & (4805) (4808) to (5605) (5608) |

FEATURES : Convertible 1 BHK

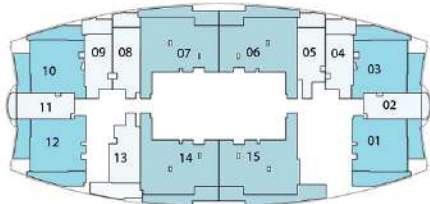

2- 19 (TYP) FLOOR

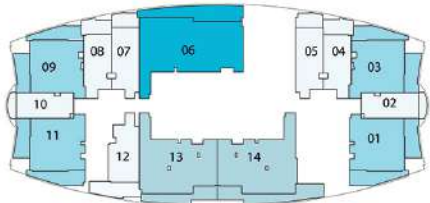

21 & 47 (TYP) FLOOR

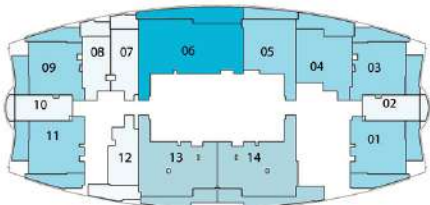

22 - 24 (TYP) FLOOR

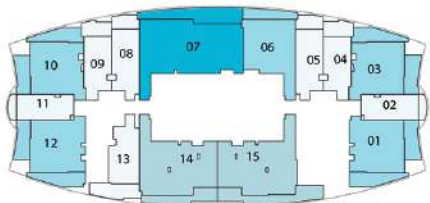

25 - 45 & 48 - 56 (TYP) FLOOR



- STUDIO
- 1 BEDROOM
- 2 BEDROOM
- 3 BEDROOM

FLOOR : 2 - 19 (Typ)

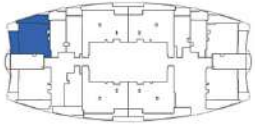

FLOOR : 21 & 47 (Typ)

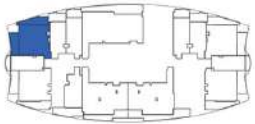

FLOOR : 22 - 24 (Typ)

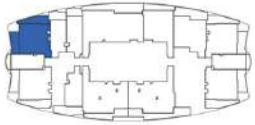

FLOOR : 25 - 45 & 48 - 56 (Typ)

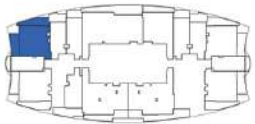

SITE PLAN



PRESIDENTIAL SUITE

AREA in Sq.Ft :

| | |
|--------------|-------------------|
| Apartment | 596 |
| Balcony | 250 to 252 |
| Total | 846 to 848 |

UNITS:

| FLOOR | UNIT Nos |
|-------------------------|-------------------------------------|
| 2 - 19 (Typ) | (210) to (1910) |
| 21 & 47 (Typ) | (2109) & (4709) |
| 22 - 24 (Typ) | (2209) to (2409) |
| 25 - 45 & 48 - 56 (Typ) | (2510) to (4510) & (4810) to (5610) |

FEATURES : Pool Office

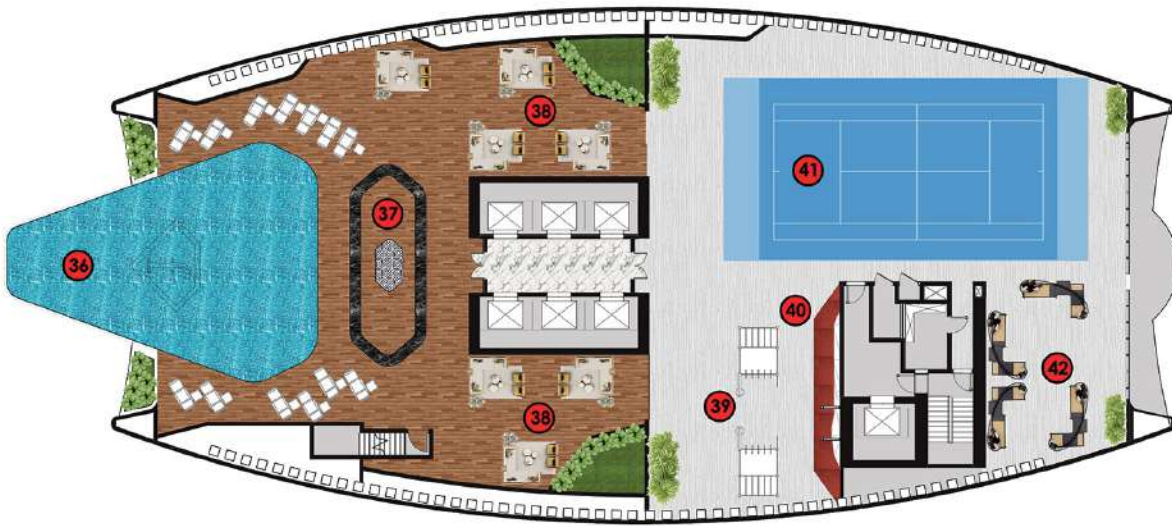

LEGEND

- 36. Roof top infinity pool
- 37. health bar
- 38. Roof top lounge
- 39. Out door gym
- 40. Rock climbing wall
- 41. Padel court
- 42. Viewing deck

ROOF HEALTH CLUB LEVEL

FASHIONZ
by DANUBE



FLOOR : 2 - 19 (Typ)

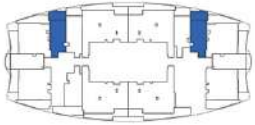

FLOOR : 21 & 47 (Typ)



FLOOR : 25 - 45 & 48 - 56 (Typ)

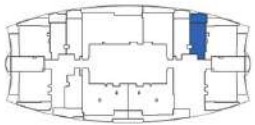

SITE PLAN



STUDIO TYPE - A

AREA in Sq.Ft :

| | |
|--------------|-------------------|
| Apartment | 335 to 336 |
| Balcony | 97 to 99 |
| Total | 433 to 434 |

UNITS :

| FLOOR | UNIT Nos |
|-------------------------|-------------------------------------|
| 2 - 19 (Typ) | (204) (209) to (1904) (1909) |
| 21 & 47 (Typ) | (2104) & (4704) |
| 25 - 45 & 48 - 56 (Typ) | (2504) to (4504) & (4804) to (5604) |

FLOOR : 2 - 19 (Typ)

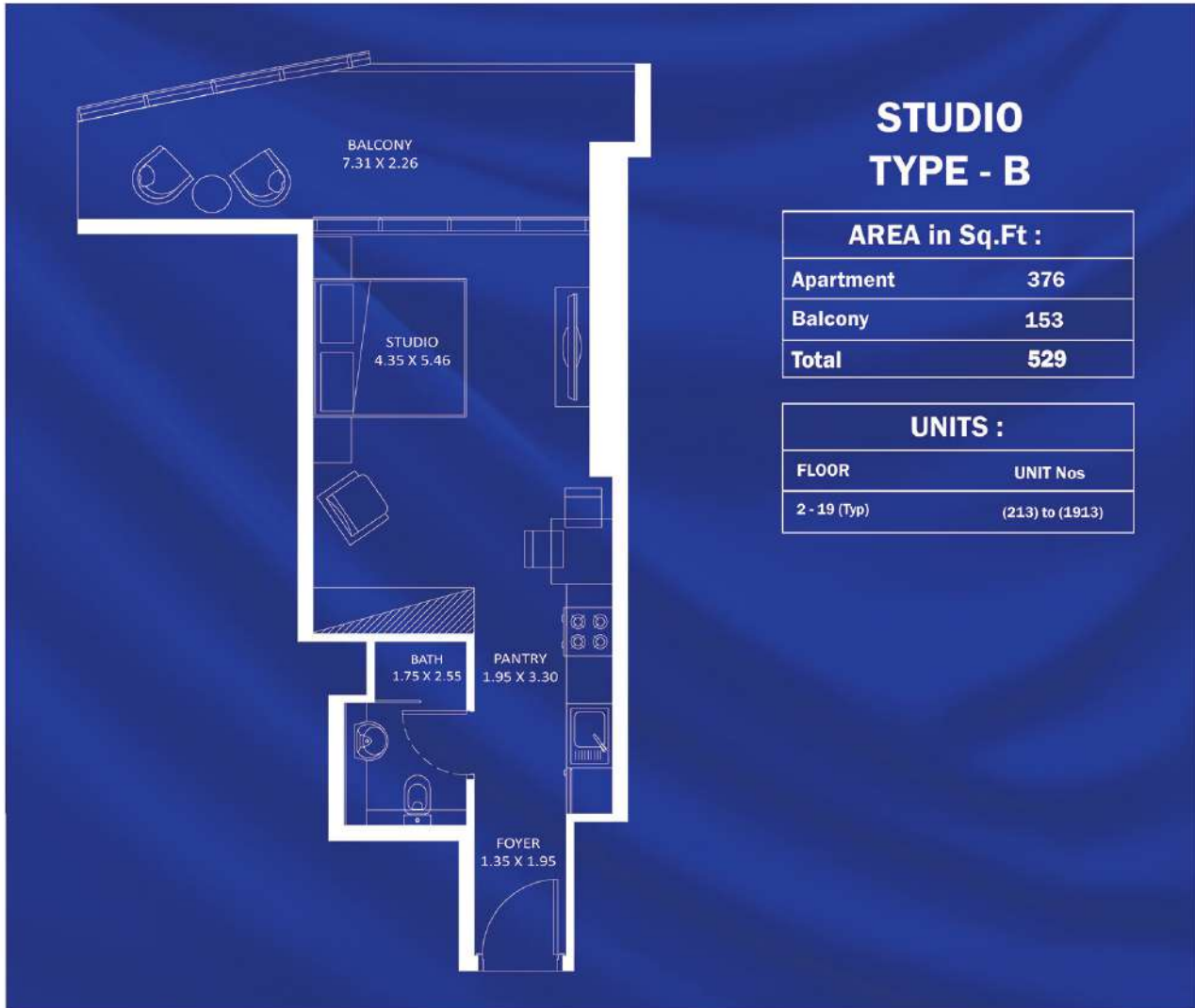
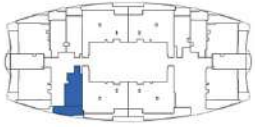

STUDIO TYPE - B

AREA in Sq.Ft :

| | |
|--------------|------------|
| Apartment | 376 |
| Balcony | 153 |
| Total | 529 |

UNITS :

| FLOOR | UNIT Nos |
|--------------|-----------------|
| 2 - 19 (Typ) | (213) to (1913) |

SITE PLAN



FLOOR : 2 - 19 (Typ)

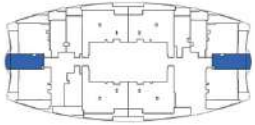

FLOOR : 21 & 47 (Typ)

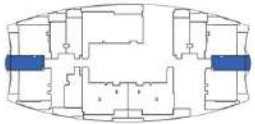

FLOOR : 22 - 24 (Typ)

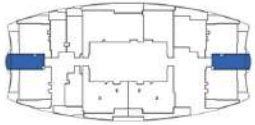

FLOOR : 25 - 45 & 48 - 56 (Typ)

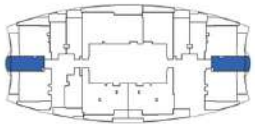

SITE PLAN

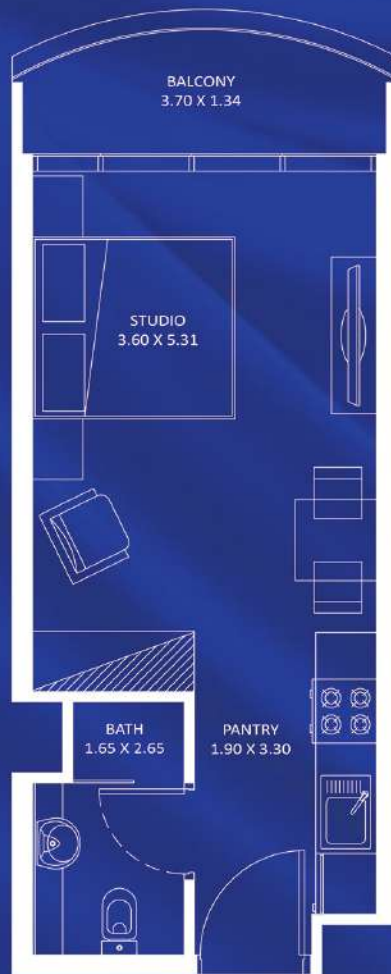

STUDIO TYPE - D

AREA in Sq.Ft :

| | |
|--------------|------------|
| Apartment | 303 |
| Balcony | 44 |
| Total | 347 |

UNITS :

| FLOOR | UNIT Nos |
|-------------------------|---|
| 2 - 19 (Typ) | (202) (211) to (1902) (1911) |
| 21 & 47 (Typ) | (2102) (2110) & (4702) (4710) |
| 22 - 24 (Typ) | (2202) (2210) to (2402) (2410) |
| 25 - 45 & 48 - 56 (Typ) | (2502) (2511) to (4502) (4511) & (4802) (4811) to (5602) (5611) |

FLOOR : 2 - 19 (Typ)

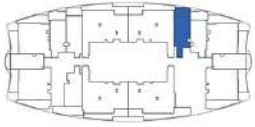

STUDIO TYPE - E

AREA in Sq.Ft :

| | |
|--------------|------------|
| Apartment | 344 |
| Balcony | 81 |
| Total | 425 |

UNITS :

| FLOOR | UNIT Nos |
|--------------|-----------------|
| 2 - 19 (Typ) | (205) to (1905) |

SITE PLAN



FLOOR : 2 - 19 (Typ)

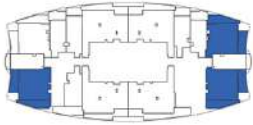

FLOOR : 21 & 47 (Typ)

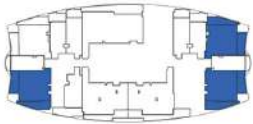

FLOOR : 22 - 24 (Typ)

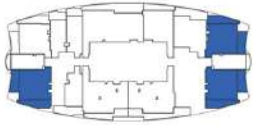

FLOOR : 25 - 45 & 48 - 56 (Typ)

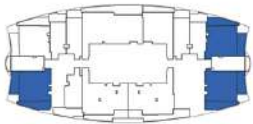

SITE PLAN



1 BEDROOM TYPE - A

AREA in Sq.Ft :

| | |
|--------------|-------------------|
| Apartment | 596 to 610 |
| Balcony | 253 to 264 |
| Total | 849 to 873 |

UNITS:

| FLOOR | UNIT Nos |
|-------------------------|---|
| 2 - 19 (Typ) | (201) (203) (212) to (1901) (1903) (1912) |
| 21 & 47 (Typ) | (2101) (2103) (2111) & (4701) (4703) (4711) |
| 22 - 24 (Typ) | (2201) (2203) (2211) to (2401) (2403) (2411) |
| 25 - 45 & 48 - 56 (Typ) | (2501) (2503) (2512) to (4501) (4503) (4512) & (4801) (4803) (4812) to (5601) (5603) (5612) |

FEATURES : Office